



# RESCUE REELS



North Carolina  
210 Labrador Drive  
Randleman, NC 27317  
Phone 336.674.0749  
FAX 336.674.3688  
[www.safeairsystems.com](http://www.safeairsystems.com)

**Worldwide Distribution and Service.**  
**1.800.424.8633**

# F1500

## FOR UTILITY OR BREATHING AIR HOSE

To handle 1/4", 3/8" and 1/2" I.D. hose.



Optional hose package shown

- Choose permanent crank rewind or chain & sprocket drive powered by an electric or compressed air motor.
- Spring actuated pinlock, adjustable cam-lock drag brake on crank rewind models.
- \*\*90° ball bearing swivel joint, 1/2" female NPT threads.
- \*\*Outlet 1/2" female NPT threads.
- Other sizes/threads can be furnished and must be specified.
- Rollers and roller mounting brackets are accessory items. Specify roller position.
- Standard finish is oven-cured enamel. Polished stainless steel discs and sprocket with chrome frame extra cost.
- F and FL1500 reels pressures to 3000 psi (207 bar)
- FH1500 reels pressures up to 6000 psi (414 bar).
- Temperatures from +20°F to +400°F (-7°C to +204°C).

### Parts Drawing – ISO 90

Model Number	Hose Capacity of Reel				Approx. Weight		Reel Dimensions***						
	feet				Crank Rewind		inches						
	m.				lb.		mm.						
For Power Rewind See Note 3	I.D. (in)	1/4"	3/8"	1/2"	NET	SHIP	A	B	E CRANK	E POWER	F CRANK	F POWER	X
	I.D. (mm)	6	10	13									
	O.D. (in)	5/8"	3/4"	7/8"									
	O.D. (mm)	16	19	22									
F1514-17-18	175	125	75	27	36*	11	6	16.5	19	19	17.25	9.5	
	53	38	23	12	16	279	152	419	483	483	483	241	
F1516-17-18	250	175	125	28	35*	13	8	16.5	19	21	19.25	11.5	
	76	53	38	13	16	330	203	419	483	533	489	292	
F1520-17-18	350	275	175	29	36*	17	12	16.5	19	25	23.25	15.5	
	107	84	53	13	16	432	305	419	483	635	591	394	

#### Notes:

Specifications subject to change.

1. Upon request, reels can be supplied with drum lengths other than shown and with disc sizes in other diameters.
2. Weights shown in chart are for manual rewind models. Add these amounts for power rewind models.

	Net (lbs.)	Ship (lbs.)	Net (kg.)	Ship (kg.)
Electric	18	18	8.2	8.2
Air	15	15	6.8	6.8

3. When ordering power rewind models, prefix model number with:

A = Air Rewind E = Electric Rewind  
(Air rewind reels are supplied with control valve and hose; 12v and 24v DC rewind reels are supplied with switch and solenoid.)

4. Model Designations:

F1500 = Utility Air Applications

FL1500 = Low-Pressure Breathing Air Applications

FH1500 = High-Pressure Breathing Air Cascade Systems

for example: EFL1514-17-18=Electric Rewind, Low-Pressure Breathing Air.

5. Add 2-1/2" to "E" dim and 1/2" to "G" dim with Assy "C" Roller installed in top wind (TR) position.

6. Manual rewind available in RT or LB configurations only.

7. Be sure to check dimensions and weights prior to ordering.

8. Some roller options may prohibit the use of our molded chain guard

**NOTICE:** A Flexible Connector must be used between the inlet pipe and the inlet swivel joint.

\*When shipped as a parcel package (via FedEx or UPS Ground)

\*\*Stainless steel required for breathing air applications.

\*\*\*x,y indicate mounting holes

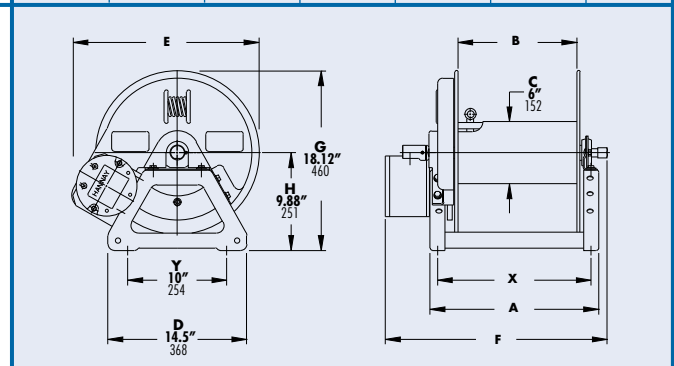

Optional External Mounting Brackets part no. 9906.0025 Add 2-1/2" to the X dimension shown in the chart.

# F2000

## FOR ALL POWER RESCUE TOOLS

To handle dual hydraulic 1/4" I.D. hose.

- Choose manual disc rewind or chain and sprocket drive powered by an electric or compressed air motor.
- Adjustable cam-lock brake on disc rewind models.
- 90° swivel joints with 1/4" female NPT threads.
- Rescue tool manufacturer must be specified to determine threads required and to determine packing material required.
- Rollers and roller mounting brackets are accessory items. Specify roller position.
- Pressures to 10,500 psi (724 bar)
- Temperatures from -20° F to +225° F (-29° C to +107° C).
- Standard finish is oven-cured enamel. Polished stainless steel discs and sprocket with chrome frame are recommended for phosphate ester oil.



Optional hose package shown



Carrying handles extra cost. (Add 2 inches to G dimension)

### Parts Drawing – ISO 101

Model Number	Hose Capacity of Reel		Approx. Weight		Reel Dimensions***						
	feet	m.	Disc	Rewind	inches						
For Power Rewind See Note 3	NOTE 1 inch = 25.4 mm				mm.						
	I.D. (in)	1/4"			A	B	E DISC	E POWER	F DISC	F POWER	X
	I.D. (mm)	6	NET	SHIP							
	O.D. (in)	.53									
	O.D. (mm)	13.5									
F2016-17-18	2/100		32	40*	13	8	16.5	19	17.5	20.5	11.5
	2/31		15	18	330	203	419	483	445	521	292
F2020-17-18	2/200		34	42*	17	12	16.5	19	21.5	24.5	15.5
	2/61		15	19	432	305	419	483	546	622	394

#### Notes:

Specifications subject to change.

1. Upon request, reels can be supplied with drum lengths other than shown and with disc sizes in other diameters.

2. Weights (lbs.) shown in chart are for manual rewind models. Add these amounts for power rewind models.

	Net (lbs.)	Ship (lbs.)	Net (kg.)	Ship (kg.)
Electric	18	18	8.2	8.2
Air	15	15	6.8	6.8

3. When ordering power rewind models, prefix model number with:

A = Air Rewind E = Electric Rewind

(Air rewind reels are supplied with control valve and hose;

12v and 24v DC rewind reels are supplied with switch and solenoid.)

4. Add 2-1/2" to "E" dim and 1/2" to "G" dim with Assy "C" Roller installed in top wind (TR) position.

5. Be sure to check dimensions and weights prior to ordering.

6. Some roller options may prohibit the use of our molded chain guard.

**NOTICE:** A Flexible Connector must be used between the inlet pipe and the inlet swivel joint.

\*When shipped as a parcel package (via FedEx or UPS Ground)

\*\*\*x,y indicate mounting holes

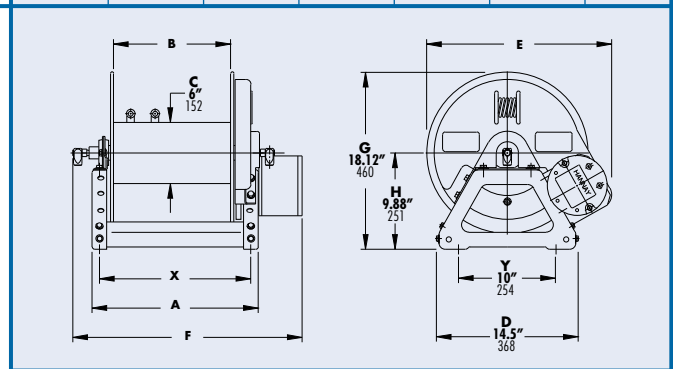

Optional External Mounting Brackets part no. 9906.0025 Add 2-1/2" to the X dimension shown in the chart.

# EF2200

## FOR CORE™ RESCUE TOOLS

To handle hydraulic Holmatro CORE Technology™ coaxial twin hose.

- Lighter weight hose and single fitting connection when compared with traditional rescue tool hose.
- Chain and sprocket drive powered by an electric motor.
- Adjustable spring drag brake standard on all models.
- CORE Technology™ swivel joint inlet and fluid path.
- Optional factory-installed 4-way roller guide available.
- Pressures to 10,500 psi (724 bar).
- Temperatures from -30°F to +225°F (-34°C to +107°C).
- Divider disc separates hose from adapter block outlet.
- Standard finish is oven-cured enamel. Polished stainless steel discs & sprocket with chrome frame available.



Left Top Shown



Optional Roller Assembly C2

### Parts Drawing – ISO 217

Model Number	Hose Capacity of Reel		Approx. Weight		Reel Dimensions****					
	feet m.		lb. kg.		inches mm.					
	NOTE 1 inch = 25.4 mm				A	B	B1	E POWER	F POWER	X
	CORE Technology™ Coaxial Hose									
	O.D. (in) O.D. (mm)	7/8" 22	NET	SHIP						
EF2220-17-18		1/100 1/31	89 40	124 56	17 432	12 305	9 229	19 483	21.62 550	15.5 394

**Notes:**

- Specifications subject to change.
1. Electric rewind models available in either 12v or 24v DC. Reels supplied with switch and solenoid.
  2. Add 2-1/2" to 'E' dimension and 1/2" to 'G' dimension with Assembly "C2" Roller installed in top wind position.
  3. **Be sure to check all dimensions and weights prior to ordering. Must specify right or left-hand configurations.**
  4. Above reels cannot be shipped via UPS or FedEx Ground.
  5. Some roller options may prohibit the use of our molded chain guard.
- \*\*\*x,y indicate mounting holes

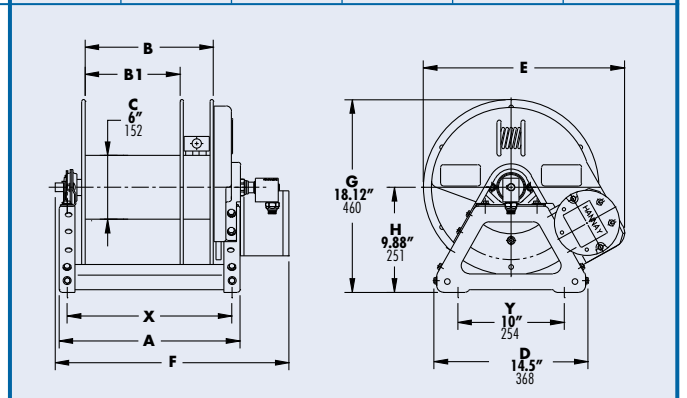

**Optional External Mounting Brackets part no. 9906.0025**  
Add 2-1/2" to the X dimension shown in the chart.

# FN700

## SPRING REWIND REELS FOR UTILITY OR BREATHING AIR HOSE

To handle 3/16" through 1/2" I.D. hose.



Standard Configuration Shown

Optional Hose Package

- Heavy-duty spring motor.
- Non sparking ratchet assembly.
- Declutching arbor.
- 90° full flow swivel joint with 1/2" female NPT threads.
- Outlet is 1/2" female NPT threads.
- Consult factory for other sizes and/or threads.
- FN and FLN700 reels pressures to 3000 psi (207 bar).
- FHN700 reels pressures up to 6000 psi (414 bar).
- Temperatures from +20° F to +400° F (-7° C to +204° C).
- Consult factory for other pressures and temperatures.
- Supplied with a 4-way roller assembly. Roller position must be specified.
- Hose stop should be used.

Roller Positions Available

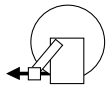

SR (STD)



VR (OPT)

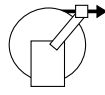

TR (OPT)

### Parts Drawing – ISO 79

Model Number	Hose Capacity of Reel					Approx. Weight		Roller Assy. Supplied on Std. Models	Reel Dimensions							
	feet m.					NET	SHIP		inches mm.							
	I.D. (in) I.D. (mm)	3/16" 5	1/4" 6	3/8" 10	1/2" 13				NX/NY indicate mounting holes		N/A	B	C	N/E	N/F	N/G
FN716-14-16C	25 8	25 8	30 9	25 8	25 8	52 24	87* 39	N204	10 254	4 102	8 203	17.62 448	13 330	16.25 413	9.12 232	8 203
FN716-16-17C	30 9	35 11	35 11	30 9	30 9	55 25	90* 41	N204	10 254	4 102	10.5 267	18.5 470	13 330	17 432	9.12 232	8 203
FN716-19-20J	35 11	50 15	50 15	50 15	50 15	64 29	99* 45	N204	10 254	4 102	10.5 267	20.75 527	13 330	20 508	10.62 270	8 203
FN715-23-24J	75 23	75 23	75 23	50 15	50 15	79 36	114* 52	N203	9 229	3 76	15.5 394	23.75 603	12 305	24 610	12.62 321	7 178
FN716-23-24G	100 30	100 30	100 30	65 20	65 20	94 43	129* 59	N204	10 254	4 102	15.5 394	23.75 603	13 330	24 610	12.62 321	8 203
FN718-25-26G	-	-	-	100 30	100 30	96 44	131 59	N206	12 305	6 152	15.5 394	25.25 641	15 381	26 660	13.62 354	10 254

**Notes:**

- Specifications subject to change.
1. Reel models and capacities shown are for standard drag applications; for vertical lift or constant tension applications consult factory.
  2. Other sizes, from standard components, available on request.
  3. Model Designations
    - FN = Utility Air Applications.
    - FLN = Low Pressure Breathing Air applications.
    - FHN = High Pressure Breathing Air Systems (6000 psi).
 For example: **FHN 716-14-16C** - is a high pressure breathing air reel.
  4. Be sure to check dimensions and weights prior to ordering.
- NOTICE:** A Flexible Connector must be used between the inlet pipe and the inlet swivel joint.
- \*When shipped as a parcel package (via Fed-Ex or UPS Ground)

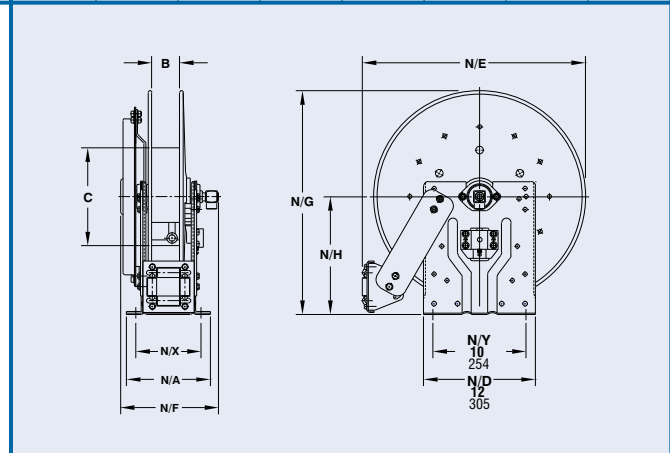

# CR16-14-16

## PORTABLE ELECTRIC CABLE REELS

- Compact, lightweight.
- Rugged construction.
- Large capacity.
- 3-conductor collector ring assembly.
- 6-foot power source lead of 12/3 cable.
- 15 amp straight blade plug (15-amp or 20-amp twist lock optional).
- Adjustable friction brake.
- Permanent crank rewind handle.



Optional 15-amp 3-prong straight blade receptacle recessed in drum.  
Part No. 9955.0090

### Parts Drawing – ISO 156

Model Number	Cable Capacity of Reel				Approx. Weight		Reel Dimensions							
	feet m.				lb. kg.		inches mm.							
	GA./NO. OF CONDUCTORS				NET	SHIP	A	B	C	D	E	F	G	H
	O.D. (in)	.39	.53	.60										
	O.D. (mm)	10	13	15										
CR16-14-16		400	200	150	24	30*	9.25	7.5	6	15.5	14	14.5	18.5	8.88
		122	61	46	11	14	235	190	152	394	356	368	470	226

**Notes:**

Specifications subject to change.

**1. Be sure to check dimensions and weights prior to ordering.**

\*When shipped as a parcel package (via FedEx or UPS Ground)

